



PrairieView Golfer



Jack Philbrick, Director
Joe Parks, Clubhouse Manager

Steve Storz, Golf Superintendent
Ken Ledene, P.G.A. Pro

1992 Vol. 2

7993 RIVER ROAD BYRON IL

(815) 234-GOLF

NEW COURSE READY!!

The Byron Forest Preserve District in Byron, Illinois, is opening a new municipal par 72, 18-hole golf course on May 2, 1992. Bent grass is used on all fairways, tees, and greens. There are 5 different sets of tees on each hole giving the course a distance of 5,625 yards to 6990 yards. The course will be open 7 days a week providing for reserved tee times along with times for walk-ins. The PrairieView Golf Course, as it is named, contains a snack bar, pro shop, and driving range to accommodate the golfer. PrairieView will also schedule leagues and play days or outings for groups desiring these activities. For groups who wish to have a meal with their outings, food catering is available with prices ranging from \$6.50 to \$12.50 depending on the type of meal desired. Beer and wine are available for play days and outings. Should there be inclement weather, a large indoor multi-purpose room, with a capacity of 200, is reserved for each outing.

PrairieView is proud to announce that the district has purchased 60 brand new canopied golf carts along with 20 hand pull carts to serve the golfer. Sets of men's, ladies, and junior golf clubs are on hand for rental services. Ken Ledene, a P.G.A. professional is on staff to provide lessons and give advice on equipment needs and purchases. Re-gripping and other club repairs are other services provided.

The Byron Forest Preserve District has attempted to build a golf course and provide for all the needs of the golfer to the extent that he or she will have a very enjoyable experience at PrairieView. Feel free to seek inquiries and to obtain reserved tee times by calling (815) 234-GOLF.

MASTER PLAN
**PRAIRIE
VIEW
GOLF COURSE**
BYRON ILLINOIS

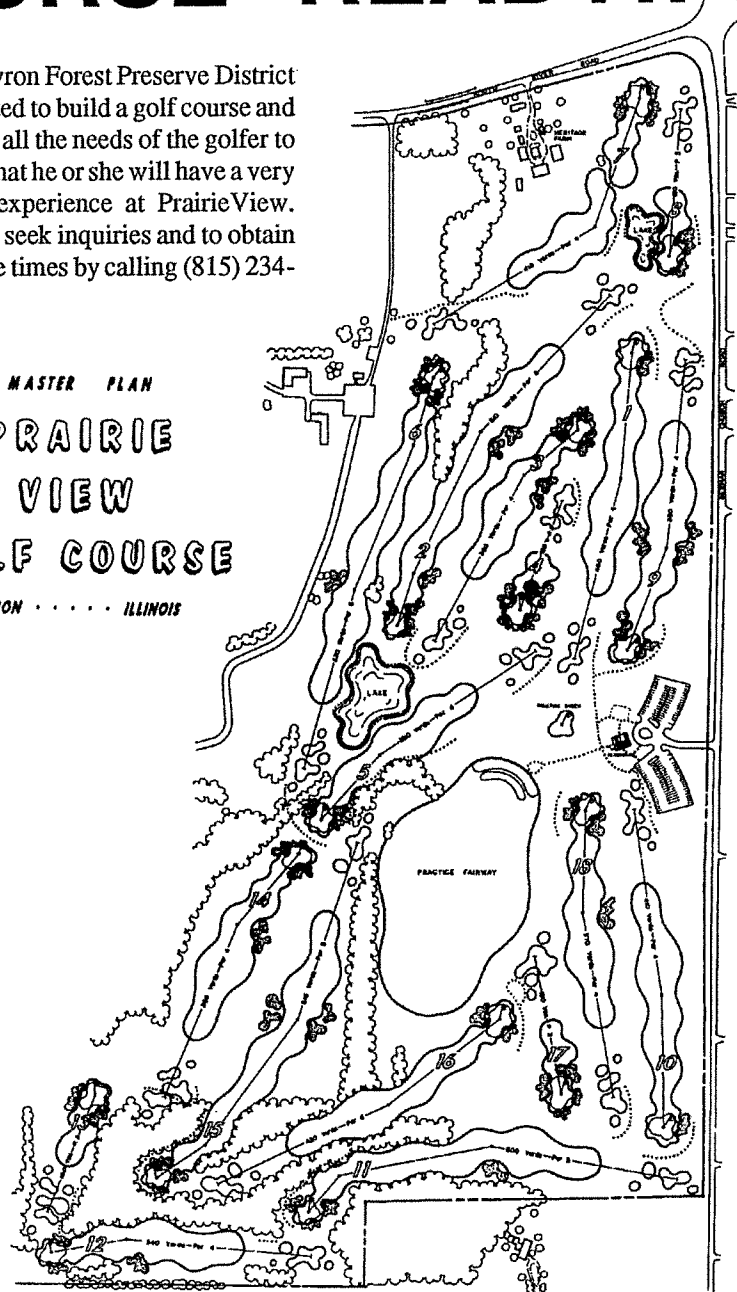

PRAIRIEVIEW GOLF COURSE INFORMATION

RESERVE TEE TIME: Reserve Tee Times are available seven (7) days a week by calling (815) 234-GOLF (4653).

Each reserve time will cost \$1 per foursome. Also available are seasonal reserve times on a first come, first serve basis, seven (7) days a week. Priority is given during certain periods to juniors, seniors, and ladies on weekdays. Play days will supersede reserve tee time (weekly and seasonal) with sufficient advance notification. It is our policy to leave every fourth tee open for walk-ins.

GOLF LESSONS: Private and group lessons will be available from Ken Ledene, Jr., our resident P.G.A. Professional, throughout the season.

	<u>1/2 Hour</u>	<u>1 Hour</u>
Adult	14.00	22.00
Adult (Series) 4/45-Minute Lessons		
1 Person -	\$60.00	
2 People -	\$90.00	

The Byron Forest Preserve District welcomes business, social and service groups desiring a play day or golf league during the 1992 season.

PLAY DAYS: For the 1992 season, play days are welcome seven (7) days a week for either 9 or 18 hole groups from 20-200 golfers. Dates are available on a first come, first serve basis with requests to be made 45 days in advance of the event.

PrairieView offers 60 canopied carts

from our own fleet with the availability to supply additional extra carts as needed. We will be able to offer a number of menu selections for a group cookout following golf in addition to our regular concession items.

Complimentary services provided for play days may include the following:

1. Beverage cart and server for all alcoholic beverages.
2. One official's cart for play days over 20 players and two for groups over 100 at no charge.

The Byron Forest Preserve District will sponsor its inaugural 36-hole "Gold Medal Classic" tournament on Saturday and Sunday, September 19-20, 1992. The tournament will be open to the public with further information forthcoming.

CORPORATE PASS: PrairieView Golf Course offers to all businesses, a special 10-Play Corporate Pass for the 1992 golf season. The ten (10) individual passes may be used in any manner; for example, promotions, entertainment, bonuses, gifts, etc. on either weekdays or weekends. Also included are complimentary tee time reservation fees.
10-Play Corporate Pass \$140.00

OUTINGS AND LEAGUE PROCEDURES

The Byron Forest Preserve District has established guidelines for groups who wish to have outings or leagues at the PrairieView Golf Course during the 1992 season.

Outings:

1. All outings are accepted on a first come, first-serve basis.
2. Tee times are restricted to 6 AM - 4 PM.
3. A deposit will be paid at the time the date is set.
4. All golf fees must be paid 10 days in advance including any reservation fee. The original deposit will count towards this reservation fee.
5. Play days must be requested 45 days in advance.
6. Outings can be 9 or 18 holes.
7. The golfers can be a minimum of 20 to a maximum of 200.
8. Reservations made six months in advance require a \$25 deposit. Others require a \$50 deposit.
9. Other requirements and information will be given upon request.

Leagues:

1. The district does not sponsor any league play. Leagues are to be run independently of the Byron Forest Preserve District.
2. Leagues will be accepted on a first-come, first-serve basis.
3. Being in a league does not guarantee "tee" time, as all league golfers are to register in the same manner as any open recreational golfer. However, through proper cooperation of the league and course manager, play on the course can be efficiently planned.
4. All league secretaries are required to notify the manager as to location, time, day, and the number of golfers along with the starting date for the league. A contact name and number should also be included.

CALL FOR RESERVATIONS

(815) 234-GOLF

FEES AND CHARGES

A. Season Permits:

Resident Adult	\$325.00
Res. Adult Couple	525.00
Non-res. Adult	400.00
Non-res. Adult Couple	600.00
Resident Sr. Citizen	275.00
Resident Sr. Couple	375.00
Non-res. Sr. Citizen	325.00
Non-res. Sr. Couple	525.00
Resident Junior*	70.00
Non-resident Junior*	80.00

B. Round Fees:

	<u>WD</u>	<u>WE</u>
Resident Adult (18 holes)	\$12.00	\$15.00
Non-resident Adult (18 holes)	14.00	17.00
Res. Sr. (18 holes)	10.00	15.00
Non-res. Sr. (18)	12.00	17.00
Res. Jr.* (18 holes)	7.00	15.00
Non-res. Jr.* (18)	10.00	17.00
League (18 holes)	12.00	15.00
Play Day (18 holes)	12.00	15.00
Res. Adult (9 holes)	9.00	11.00
Non-res. Adult (9)	11.00	13.00
Res. Sr. (9 holes)	8.00	11.00
Non-res. Sr. (9 holes)	9.00	13.00
Res. Jr.* (9 holes)	7.00	11.00
Non-res. Junior.* (9)	10.00	13.00
League (9 holes)	9.00	11.00
Play Day (9 holes)	9.00	11.00
10-Play Corporate	140.00	140.00

* All juniors must be accompanied by an adult when outside designated junior play hours.

C. Miscellaneous Fees:

	<u>WD</u>	<u>WE</u>
Motorized Carts (18)	\$13.00	\$15.00
Motorized Carts (9)	10.00	12.00
Private Carts	6.00	8.00
Pull Carts		1.00
Reserve Time (4-some)		1.00
Reserve Time		
Playday Foursome	2.00	
(Negotiable authority permitted)		
Club Rental	5.00	
(Driver's License for Deposit)		
Driving Range Club	1.00	
Driving Range (Sm. Bucket)	1.50	
Driving Range (Lg. Bucket)	2.00	
Driving Range Coupons (12 Small Buckets)	15.00	

PrairieView Golf Course can be reached from the east and the west by driving Route 72. Golfers from the north and south can travel Route 2. The course is situated along German Church Road which extends from Route 72 at Byron to Route 64 to the south. I-90, I-80, and I-39 are other main highways intersecting Route 2 and Route 72.

PRAIRIEVIEW GOLF COURSE

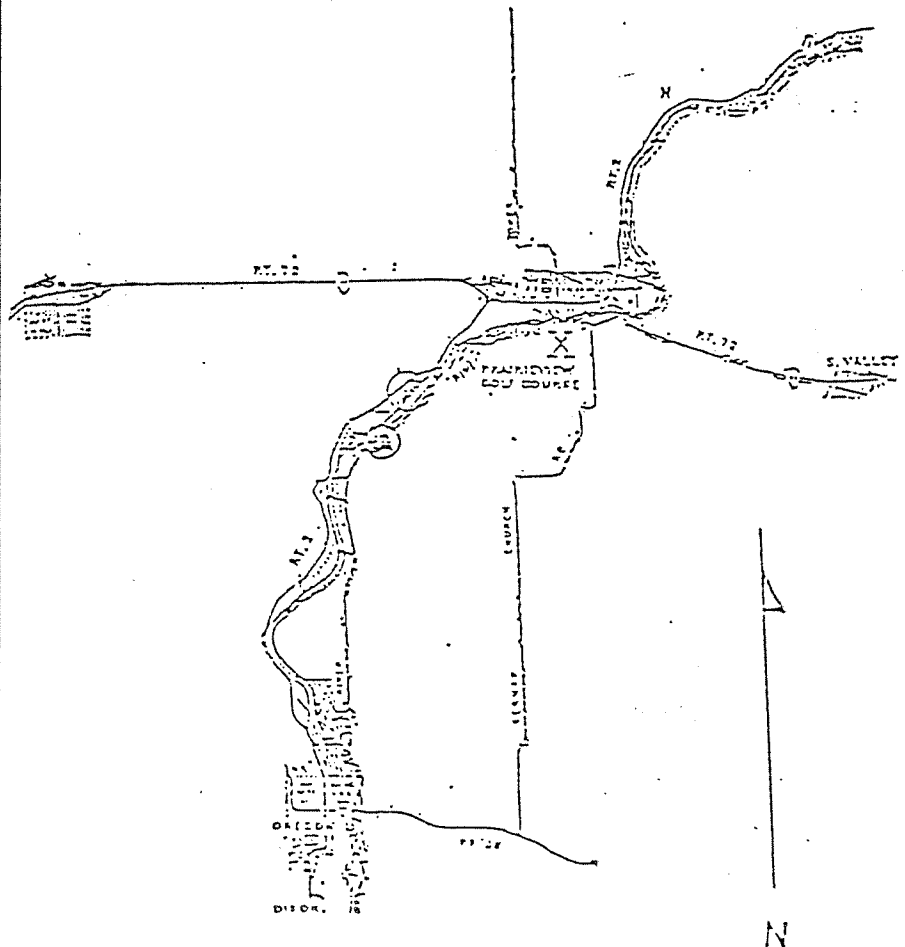

(815) 234-GOLF

**BYRON FOREST PRESERVE DISTRICT
7993 RIVER ROAD
BYRON IL 61010**

**BULK RATE
U.S. POSTAGE PAID
BYRON, ILLINOIS
PERMIT NO. 50**

**POSTAL PATRON
BYRON IL 61010**



PrairieView Golfer



Jack Philbrick, Director
Ken Ledene, Clubhouse Mgr. & PGA Pro

Steve Storz, Golf Superintendent

1992 Vol. 3 7993 N. RIVER ROAD BYRON IL (815) 234-GOLF

GOLF NOTES...

By PGA Pro Ken Ledene

August will mark the midpoint of our first season of operations here at PrairieView. For those who played back in early May and have witnessed the dramatic improvements and maturing of the golf course, the month of August promises even more improvements of PrairieView. Sand traps will be completed, new cart paths paved for added ease in moving about the course, and faster greens as a result of ideal turf growing conditions this summer.

Prior to our unseasonal damp, cool mid-July weather, play on the course was on a steady increase. With dry, warmer conditions returning, August will witness a huge increase in play as evidenced by the overwhelming demand for playdays. With the busy August playday schedule, we do apologize for any inconvenience and request that golfers call the Pro Shop for information on the availability of the course and reserve tee times. Our policies for accepting playdays, their size, the number, and the times allowed will all be closely evaluated after this first season to establish future policy.

CHIPSHOTS!!

Joe Parks scores the first official hole-in-one on the 8th hole with a three iron on Thursday, July 15th!! (Second official hole-in-one for the course.) Joe had plenty of witnesses as he was playing a makeup match for the Byron Men's League. Congratulations Joe on your fourth hole-in-one!! ...Dennis Dunham is actively seeking individuals interested in forming a golf association for men, women, and junior players at PrairieView

next season. Sign-up sheets and information posters will be available in the clubhouse. ...Our first PrairieView sponsored golf tournament will be held on Saturday and Sunday, September 19-20, 1992. Play will be 36 holes over two days with men's and women's divisions, flights within divisions, and a flighting format that will not require established handicaps. More details and entry forms available in August. ...Several promotions over the past few months have been very successful in bringing area golfers to PrairieView to see and try our new facility. Look for several new promotions this coming month and bring some friends with you to see our tremendous golf course and the progress we are making towards being the best golf facility in Northern Illinois!!

GOLF LESSONS

Lessons will be offered for ages 11 - 18 for a \$35.00 fee. This will include 18 holes and range balls. We will offer two sessions, starting August 3 and August 10. Each session will last two weeks. (We have a very limited supply of rental clubs available.)

Instructor: Jamie Hogan

- Instructor at Cyclone Golf Camp (recognized by Sports Illustrated)
- Taught a semester of Golf Class at Iowa State University
- Attended two week instructional school in LaQuinta, California (Sponsored by PGA)
- 4 year letterman at division one school NCAA Finals participant
- Holds Big "8" Conference record for most birdies carded in tournaments history
- All time low scoring average for an Iowa State golfer and lowest tournament total.

PLAYDAYS AND LEAGUES AT PRAIRIEVIEW (SUBJECT TO CHANGE - PLEASE CALL 234-GOLF)

	Monday Evening League	4:00-5:12	Aug. 27 Thursday DPMA (100+)	9:04-12:56
Aug. 1	Saturday Holcomb Fire Dept. (100+) Shotgun	6:30-11:30	Aug. 29 Saturday Ogle County Hospice (120+) Shotgun	12:00-5:04
Aug. 2	Sunday Svithiod Club (28)	8:08-9:12	Aug. 29 Saturday Suntec (48-60)	7:04-8:32
Aug. 8	Saturday 3-L Club (90+) Shotgun	7:04-12:16	Sept. 12 Saturday Specialty Screw (20-30)	8:24-9:20
Aug. 9	Sunday Sundstrand (120+) Shotgun	7:00-12:00	Sept. 12 Saturday Sundstrand (30-40)	10:08-11:20
Aug. 15	Saturday RIAA (144) Shotgun	7:00-12:32	Sept. 13 Sunday Knodle Fundraiser (120+) Shotgun	1:00-6:00
Aug. 22	Saturday Belvedere Co. (55-65)	8:08-10:32	Sept. 19 Saturday Gold Medal Classic	ALL DAY
Aug. 22	Saturday Holcomb State Bank (25-30) 9holes	1:30-2:24	Sept. 20 Sunday Gold Medal Classic	ALL DAY
Aug. 23	Sunday Maple Park Golf League (20)	8:08-8:40	Oct. 26 Monday Seniors - 50 and over	9:36-1:04
Aug. 23	Sunday Hartzog Aviation (32-36)	10:00-11:04		

TURF NOTES...

By Golf Supt. Steve Storz

It has been a busy summer for the maintenance crews at PrairieView. Though we have not yet achieved all of our objectives, much has been accomplished.

As a result of favorable weather conditions, turf establishment has been excellent. For numerous reasons, PrairieView looks much more like a golf course than it did opening day, May 1. At the time of this writing, the greens have completed a necessary growing phase and we are in the process of increasing their speed and trueness. You should begin to notice a dramatic improvement in their putting characteristics. Thanks to the Park Maintenance crew, only 11 uncompleted sand traps (out of 60) remain and six of those are cored and ready for sand. On Friday, July 24, 1992, Rockford Blacktop finished the coring and graveling of an additional two (2) miles of cart paths. This will greatly facilitate cart travel especially on the back 9 holes.

Thank you very much for your patience and support during this time of development. Soon, PrairieView will become a golf course we can all be proud of.

GOLF COURSE STATUS

The following is information on activity to date of the PrairieView Golf Course:

Number of Passes Sold

Adult - 20

Junior - 18

Number of Playdays	11
Number of Leagues	2
Golf ID's	628
Corporate Passes	12

Finance Activity thru June:

Pro Shop Sales	6,170.68
Golf Fees (includes Play, Reserve Time, Lessons, Certificates, Golf ID's, Passes.)	78,099.24
Concession Sales	18,360.04
Carts	21,860.24
Driving Range	5,927.15

Total Dollar Amount thru June	\$130,417.35
----------------------------------	--------------

**PRAIRIEVIEW GOLF COURSE
7993 N. RIVER ROAD
BYRON IL 61010**

**BULK RATE
U.S. POSTAGE PAID
PERMIT NO. 50
BYRON IL 61010**



PrairieView Golfer



Jack Philbrick, Director
Ken Ledene, Clubhouse Mgr. & PGA Pro

Steve Storz, Golf Superintendent

1992 Vol. 4

7993 N. RIVER ROAD

BYRON IL

(815) 234-GOLF

PUBLIC GOLF MEETING

PrairieView Golf Course and the Byron Forest Preserve District will host a public golf meeting on Saturday, November 21, 1992, from 9 until 11 AM.

The meeting will be held at the Jarrett Prairie Center in the lower level of the multi-purpose room.

All Resident I.D. Cardholders and Season Pass Holders are invited and encouraged to attend this meeting.

The purpose of this meeting will be to allow the public and staff to discuss

this past golf season. The public will be able to voice their opinions and ideas for the 1993 golf season.

Discussion areas may include operating procedures, fees, passes, reservations, cart rentals, leagues, tournaments, etc.

This discussion will allow the staff to take input from the public before proposing the 1993 operations for PrairieView Golf Course.

GOLF COURSE CLOSING

The golf course will officially close for the season after **Sunday, November 1, 1992.**

Work will continue even after the course closes. This will include rough clearing, tree planting, and pruning that will help shape the course for next season.

PRAIRIEVIEW GOLF ASSOCIATION

Plans and organizational meetings continue to move forward for the establishment of a "PrairieView Golf Association".

Promoter, organizer, and avid golfer, Dennis Dunham, plans to hold the second organizational meeting beginning at 11 AM following the public golf meeting on November 21, 1992. Open to men, women, and youths interested in devel-

oping an association of individuals wishing to establish group leagues, tournaments, junior programs, education programs, etc., this meeting is important for establishing a steering committee for the upcoming season. For those wishing to contact Mr. Dunham or requesting additional information, please stop by or call the PrairieView Clubhouse at (815) 234-GOLF.

Tournament Was Successful!!

The first annual PrairieView Gold Medal Golf Tournament was successfully held on September 19-20, 1992, with 48 entries playing 36 holes of golf over the two days. Golf Course Superintendent Steve Storz and staff are to be commended for their efforts in getting the course ready for this first tournament ever at PrairieView.

The players were very positive in their comments about the bent grass fair-

ways, the speed and overall condition of the "double cut" greens, and the prospects for the future growth of this amateur event.

The event, open to both men and women, flighted players after 27 holes of competition. The overall champion was Bob McGavran of Rockford, posting a terrific score of 152 despite adverse conditions for the second round.



Pictured above-Bob McGavran of Rockford. He was the overall champion of the first annual PrairieView Gold Medal Golf Tournament scoring 152.

TURF NOTES...

By Golf Supt. Steve Storz

During the past few weeks, golfers have experienced soil plugs and grass plant debris being strewn across the fairways at PrairieView Golf Course. This is the result of a maintenance procedure called "aeration". Simply stated, an aerator rapidly pushes into and pulls out of the ground a series of hollow, steel tines which remove cigar-sized plugs depositing them on the surface.

Aeration serves a threefold purpose. Turf, particularly bent grass, forms a dense network of stems, grass blades, roots, and mower clippings called "thatch" which tends to slow down the rapid penetration of water into the soil. It forms, in essence, a thatched roof over the ground. Disruption of the thatch layer by aerator is especially important on sloped areas where water tends to run off quickly and not soak in.

Plant roots, like human beings, require oxygen to break down carbohydrates, their energy source. Tiny spaces

between soil particles frequently allow too little air to infiltrate into the soil structure. Resulting shallow, weak roots can't do an efficient job of absorbing water and dissolved minerals. This decreases the vigor of the whole grass plant. A cross section of an aerated soil profile will reveal a profusion of healthy, white roots in aerator holes.

Some stands of turf are too thin while others, like our bent grass fairways, have grown too thick and need thinning. The shattering and back dragging of plugs can help to improve both situations. In thin areas, the topdressing provides excellent conditions for germinating grass seed. This same topdressing contains microbes that assist in the decomposition of organic matter, accelerating the breakdown of the thatch layer.

Aeration is recommended for athletic fields and home lawns--any place where turf is grown. In most cases, this process will improve stands of turf grass.

GOLF NOTES...

By PGA Pro Ken Ledene

Anyone wishing to apply for a clubhouse position for the coming 1993 season, applications will be accepted starting December 20, 1992, and interviews will take place in February and March.

Several lost items have been turned in and lay unclaimed this past season. If you wish to claim a lost item, please call or stop by the clubhouse before the closing date.

The Chicago District Golf Association indicates that the course will be re-measured and a course and slope rating established before closing day. Rating the course will allow PrairieView to offer a computer handicap service for next season.

PrairieView Clubhouse offers the opportunity for gift purchases including gift certificates for items such as golf lessons, motorized golf carts, and season passes. These gifts will still be available for purchase after the course closes on Sunday, November 1, 1992.

**PRAIRIEVIEW GOLF COURSE
7993 N. RIVER ROAD
BYRON IL 61010**

**BULK RATE
U.S. POSTAGE PAID
PERMIT NO. 50
BYRON IL 61010**